

1/4" Mono Open Frame

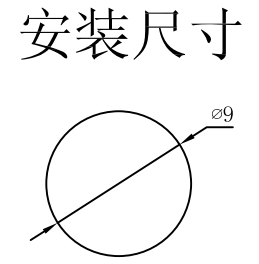
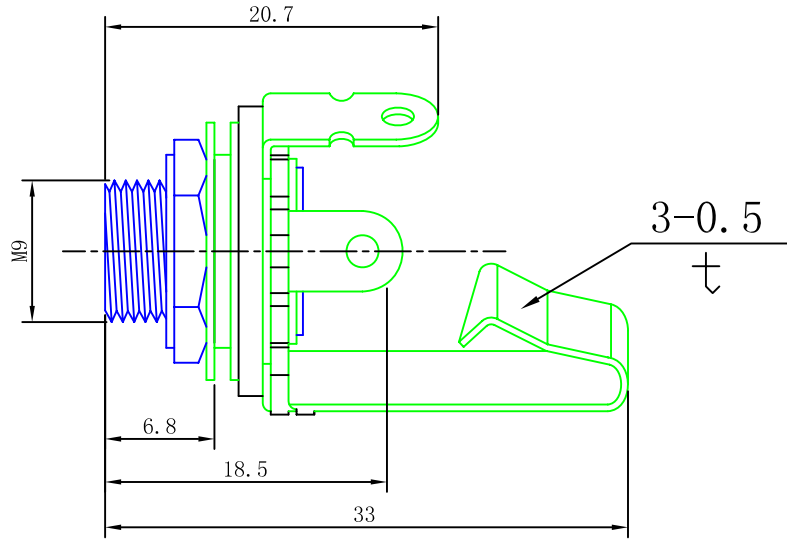
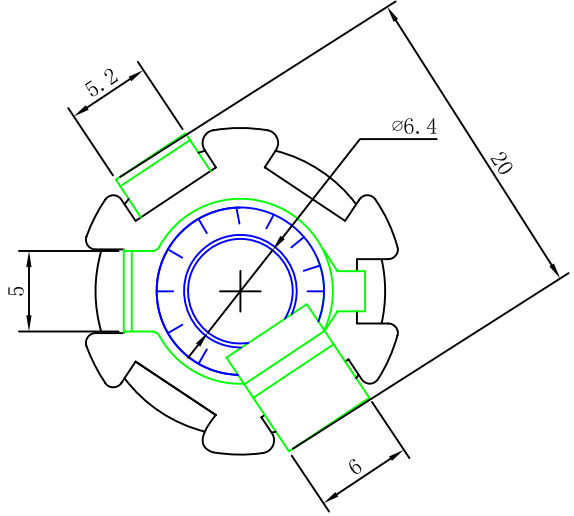

NOTES:

- 1. MATERIALS:
- BUSHING - COPPER ALLOY, NICKEL PLATED
- TIP SPRING - PLATED SILVER
- SLEEVE TERMINAL - COPPER ALLOY, SILVER PLATED
- INSULATING WASHERS - PLASTIC
- JACK WASHER - STEEL, NICKEL PLATED
- HEX NUT - COPPER ALLOY, NICKEL PLATED
- MOUNTING WASHER - STEEL, NICKEL PLATED

借(通)用件登记
描图
描校

★ STAR SYMBOL DENOTES CRITICAL DIMENSION
UNLESS OTHERWISE SPECIFIED

1. ALL DIMENSIONS IN INCHES
-TWO PLACE DECIMALS ±0.02

旧底图总号						
底图总号						
签字						
日期	REN	ECO NUMBER	DATE	BY	APVD	

标记	处数	分区	更改文件号	签字	日期							
设计				标准化					阶段标记	数量	重量	比例
校对										1		2:1
审核												
工艺				批准					第一页	第一张		

Yueqing Daier electron co., ltd.

1/4" Mono Open Frame

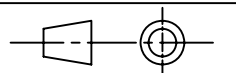

REVISIONS

DO NOT SCALE DRAWING